

Abatement Plan Basement Level – Greene Residence, Wooster, Ohio

Abatement Procedures:

- Workers will be required to wear Tyvek suits (with head and booties), half face air purifying respirators with HEPA filters, goggles, and gloves during ALL abatement procedures.
- Shut down HVAC system. If necessary, install supplemental heating and dehumidification to maintain appropriate environmental conditions. If it is not possible to shut down HVAC system, cover as many supply (cold air) returns as possible. **Consult licensed HVAC contractor for assistance in isolating HVAC system.**
- Construct decontamination chamber at bottom of basement stairs; isolating basement from 1st floor areas. Place basement area under negative pressure containment.**

REMOVAL OF CONTENTS AND BUILDING MATERIALS WILL BE THROUGH EAST BEDROOM AREA

- Remove **ALL** remaining furniture and contents from structure. Coordinate with homeowner on items to be cleaned and those that will be discarded. Porous items that are showing visible signs of mold contamination should be discarded. Refer to general cleaning guidelines for additional information.
- Carry all furniture and contents directly from the structure to the outdoors where they will be cleaned and stored, either on-site or at a storage location. Articles that will not be cleaned will be placed in sealed roll-off container, which is to be located on-site. Roll-off container to be secured and properly labeled. Mold contaminated material can be disposed of in an approved solid waste landfill.
- Remove all **mold contaminated** building materials, to include but not limited to: (1) drywall (refer to Figure 1-1 for recommended locations), (2) insulation, (3) carpeting and pad throughout.
- Removal of drywall in the east bedroom closet will initially be limited to lower 2'; unless further mold contamination is discovered during removal.
- All drywall removal will need to extend 2' beyond visible signs of mold contamination.**
- Remove approximately 1' x 1' sections of the drywall along exterior walls (as noted) to investigate for mold.

THERE IS EXTENSIVE SURFACE MOLD CONTAMINATION ON CABINETS AND BUILT-INS THROUGHOUT BASEMENT

Containment Procedures / Basement:

- Set-up decontamination chamber at bottom of basement stairwell.
- Completely seal off basement area entrance with double layers of overlapping 6-mil polyethylene (i.e. poly) or single layer of 6-mil poly utilizing a Zip-Wall® structure.
- Set-up and operate air filtration devices (AFDs) and air scrubber at locations specified in Figure 1-1.
- Cover all critical barriers (e.g. windows, doorways, registers, ductwork openings, etc.) with 6-mil poly sheeting. **Important, prior to isolating HVAC system or covering ductwork openings consult licensed HVAC contractor.**
- Place work area under negative pressure containment (operating at – 0.02 column inches of water) and run sufficient AFDs to ensure at least four (4) complete air changes per hour in respective work area.

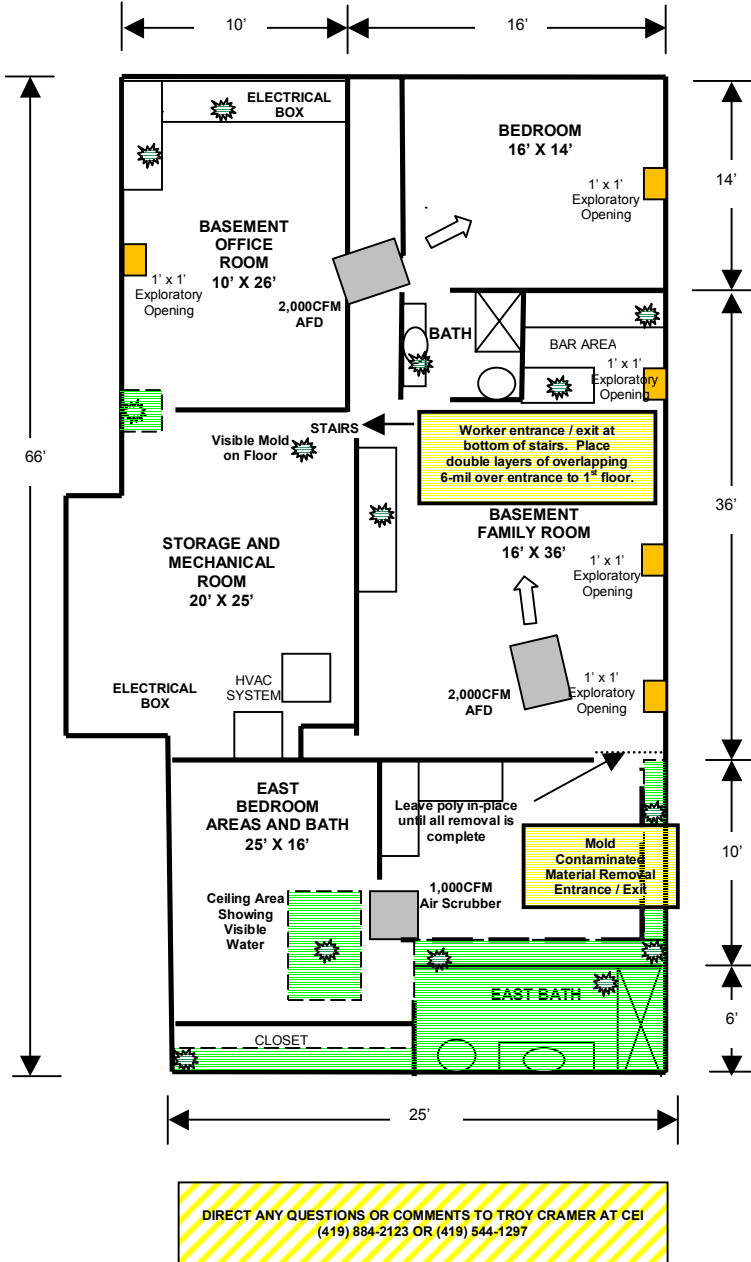

DIRECT ANY QUESTIONS OR COMMENTS TO TROY CRAMER AT CEI
(419) 884-2123 OR (419) 544-1297

- Use abrasive scrub pads or other conventional means (e.g. scrubbing, sanding, wire brushing, etc.) to thoroughly remove visible signs of mold contamination from wood framing and concrete walls.
- HEPA vacuum and wipe down (using water and detergent) all surfaces (floors, walls, and ceilings). **All loose debris, dust, will need to be cleaned up. There is extensive surface mold contamination on and inside cabinets and built-ins that will need removed and areas thoroughly cleaned.**
- Wipe down all surfaces and material which exhibited signs of mold contamination with **TWO (2)** separate applications of Sporidicin® antimicrobial.
- Wait **60** minutes and reapply antimicrobial.
- Wait **60** minutes and clean all surfaces (floors, walls, and ceilings) with water and detergent.
- HEPA vacuum all surfaces (floors, walls and ceilings) one final time.
- Conduct clearance air sampling.

HEPA Air Filtration Devices

- Place 2 - 2,000 CFM AFDs (exhausting to the outside) in the basement.
- Place 1 - 1,000 CFM Air Scrubber (exhausting to the inside) in the east bedroom. Exact location of AFDs to be field verified.





IMPORTANT!

- Establish critical barriers by placing poly sheeting over all windows, doorways, and HVAC openings (as directed by HVAC contractor).
- Do not remove containment until clearance is granted by CEI.
- Cover all electrical outlets **PRIOR** to spraying any liquid.
- Once mold abatement activities are completed, contact contractor to clean entire HVAC system and any remaining sheet metal ductwork. Cleaning of the HVAC system must be performed in accordance with NADCA Standard ACR 2006, Assessment Cleaning and Restoration of HVAC Systems.

General Cleaning of Contents

- NON-POROUS SURFACES** will need to be thoroughly wiped down and HEPA vacuumed to remove any mold spores. Suggest using microbial cleaner *instead* of 1:10 bleach / water solution on all wood surfaces, so as not to damage material.
- BASED ON THE ELEVATED MICROBIAL LEVELS PRESENT IN THE STRUCTURE ALL POROUS ARTICLES SHOULD BE DISPOSED OF UNLESS ABSOLUTELY NECESSARY TO SAVE. POROUS ARTICLES TO BE SAVED** need to be thoroughly HEPA vacuumed and washed to remove any mold spores. If there are any visible signs of mold contamination, these articles should be disposed of.

KEY

-  Air Filtration Device / Air Scrubber
-  6-Mil Poly Sheeting
-  Drywall Ceiling and Wall for Removal
-  Visible Mold Detected on Surface / Drywall
-  Moisture Investigation Area (1' x 1' Opening)

Certified Environmental, Inc.

60 Foxcroft Circle
Lexington, Ohio 44904
(419) 884-2123
Fax (419) 884-0978

FIGURE 1-1

Greene Residence – Basement Level

DRAWN BY: TAC

SCALE: NONE

DATE: NOV 2009